

2. Radii to be R0.5 max unless otherwise specified.  
 1. Unless otherwise specified dimension are in millimeters tolerances on  $\pm 0.1$ , angle  $\pm 1^\circ$ .

Note

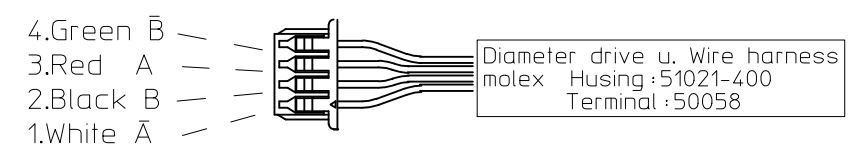
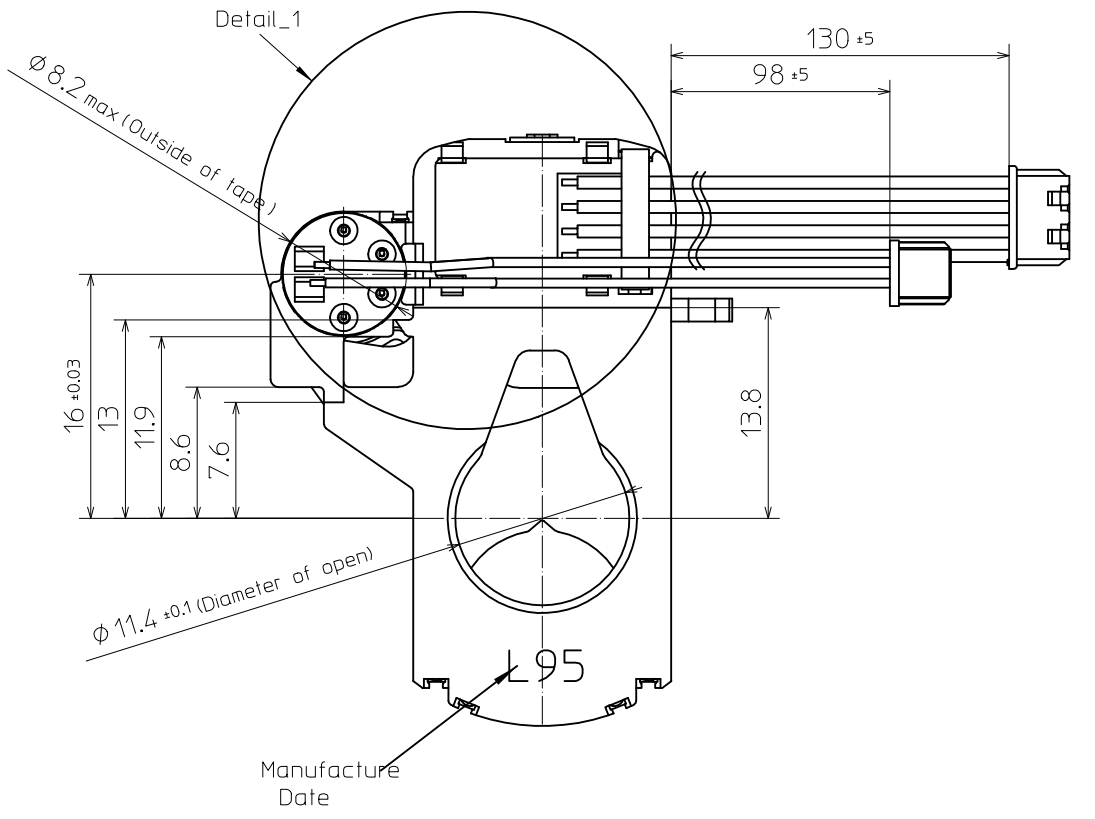
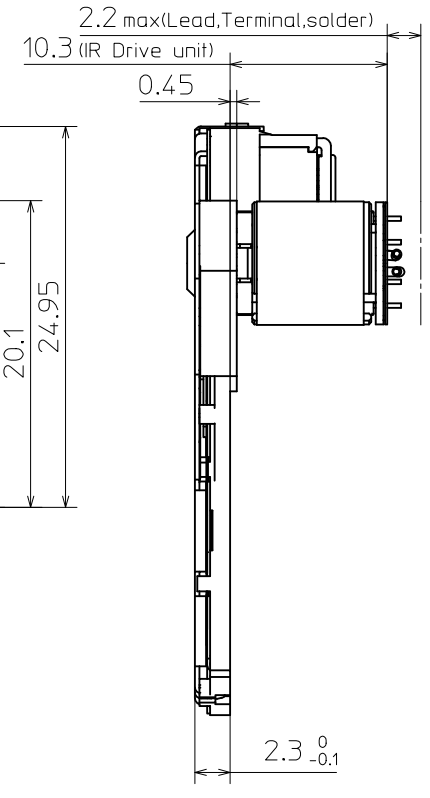
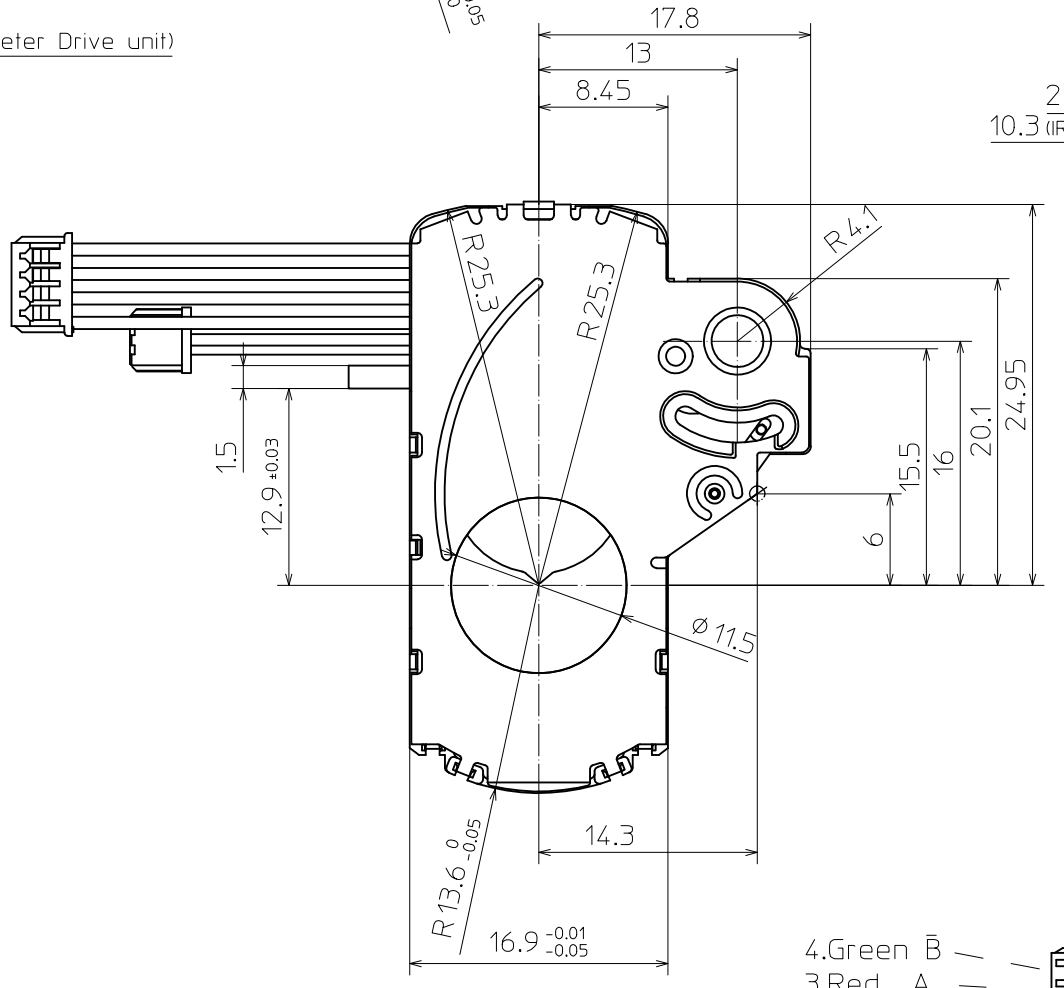
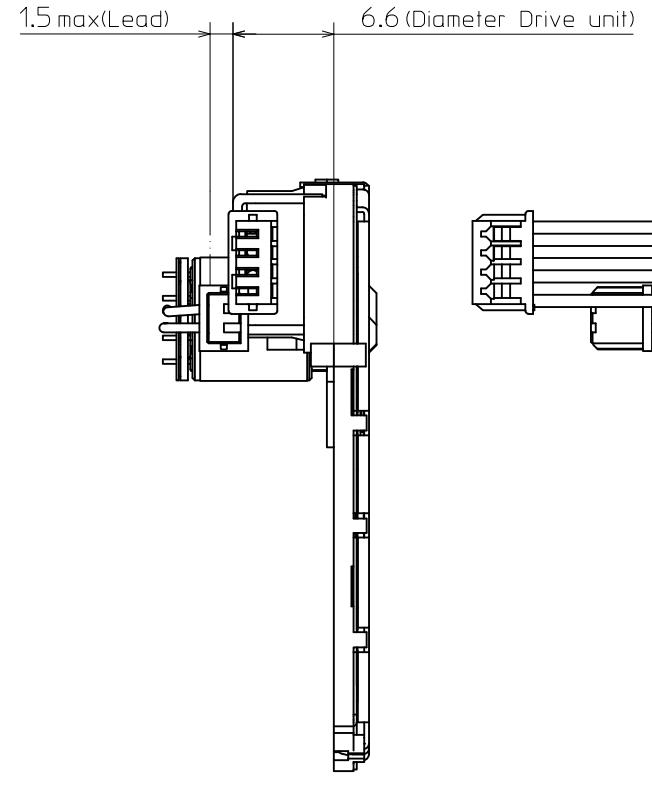
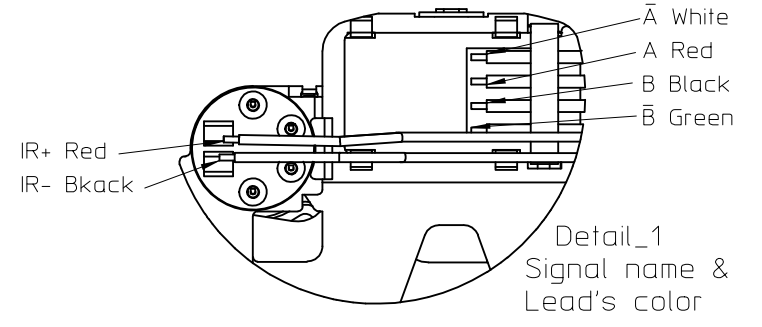
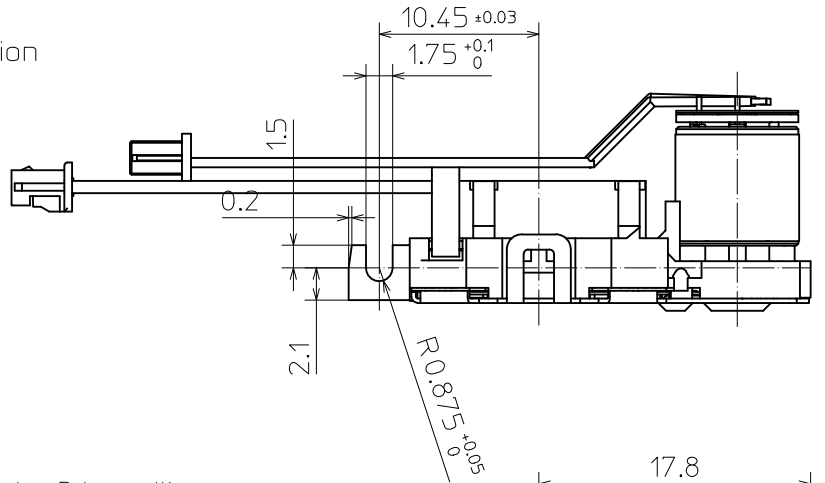

SURFACE TREATMENT		ANNEAL		SURFACE ROUGHNESS		SCALE 2:1	
						MATERIAL	
						DRAWING-NAME	
						N114DNP	
						Appearance Drawing	
						DRAWING-NUMBER	
						NA06-0607 -Ap/01	
						SHEET	
						OF	
01	New drawing	12/10/17	N.M	New Asia Optical Industry			
INDEX	DESCRIPTION	DATE	NAME				